

SERVICE PARTS LIST

GROUP:	17B
FORM:	8AR
FILE:	Alternator Parts List Section
DATE:	November, 1994

MODEL	VOLTS	AMPS
Various See Table		

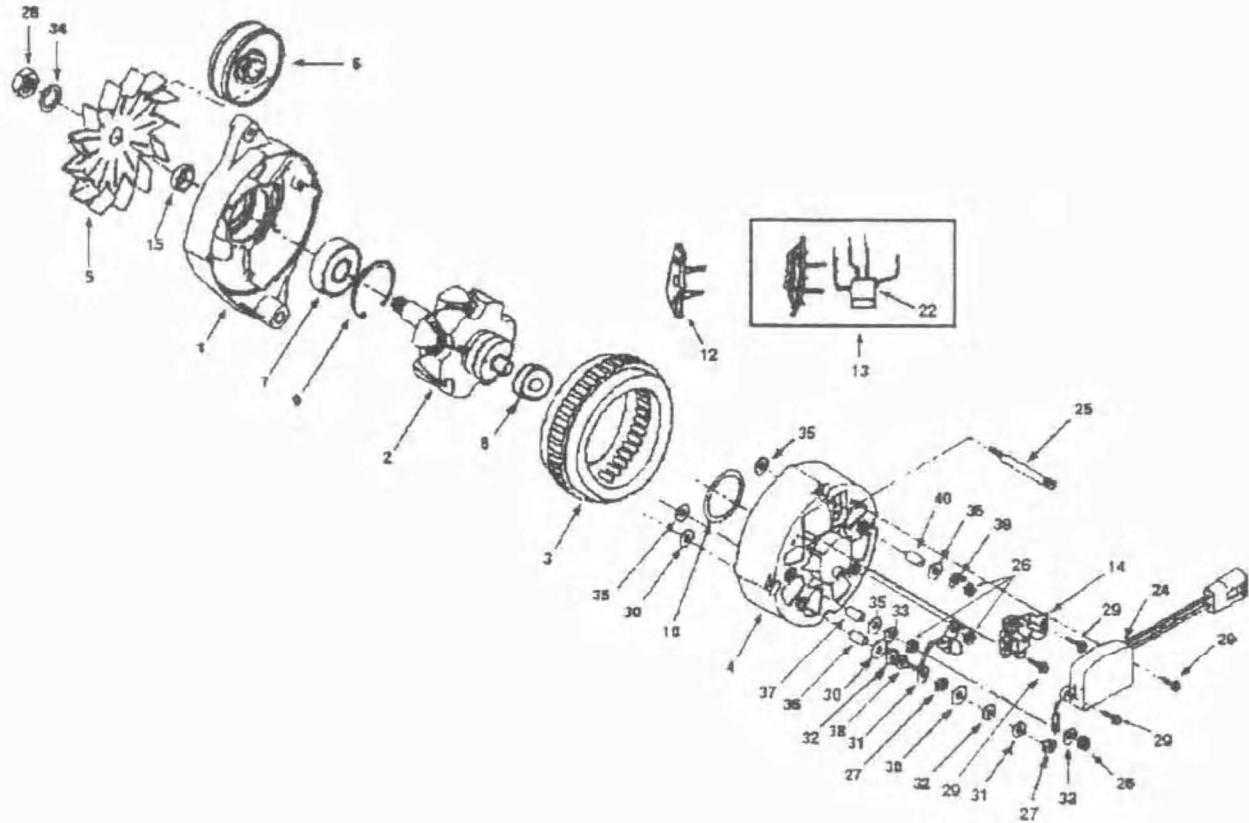

MODEL NO.	SALES NO.	1 HSNG FRONT	2 ROTOR ASSEM	3 STATOR ASSEM	4 HSNG REAR	5 FAN	6 PULLEY	7 BRNG FRONT	8 BRNG REAR	9 FR. BRNG RET	10 R. BRNG RET	11 DIODE ISOLATION	12 DIODE REC.NEG.
8AR2200L	110-460	114-261	112-81	113-71	114-98			111-78	111-23	111-81	111-25		101-229
8AR2201L	110-461	114-261	112-81	113-71	114-98			111-78	111-23	111-81	111-25		101-229
8AR2202L	110-463	114-261	112-81	113-71	114-98	107-82	107-92	111-78	111-23	111-81	111-25		101-229
8AR3200G	110-462	114-261	112-80	113-70	114-98			111-78	111-23	111-81	111-25		101-229

Important: The information contained in this bulletin is intended for use by trained, professional technicians who have the proper tools, equipment, and training to perform the required maintenance described above. This information is NOT intended for 'do-it-yourselfers', and you should not assume that this information applies to your equipment. If you have any questions regarding this information please visit our website at www.prestolite.com, or contact our technical service department at:

Leece-Neville Heavy Duty Systems
7585 Empire Drive
Florence, KY 41042

Phone/Fax: (866) 288-9853
webmail@prestolite.com

GROUP:	17B
FORM:	8AR

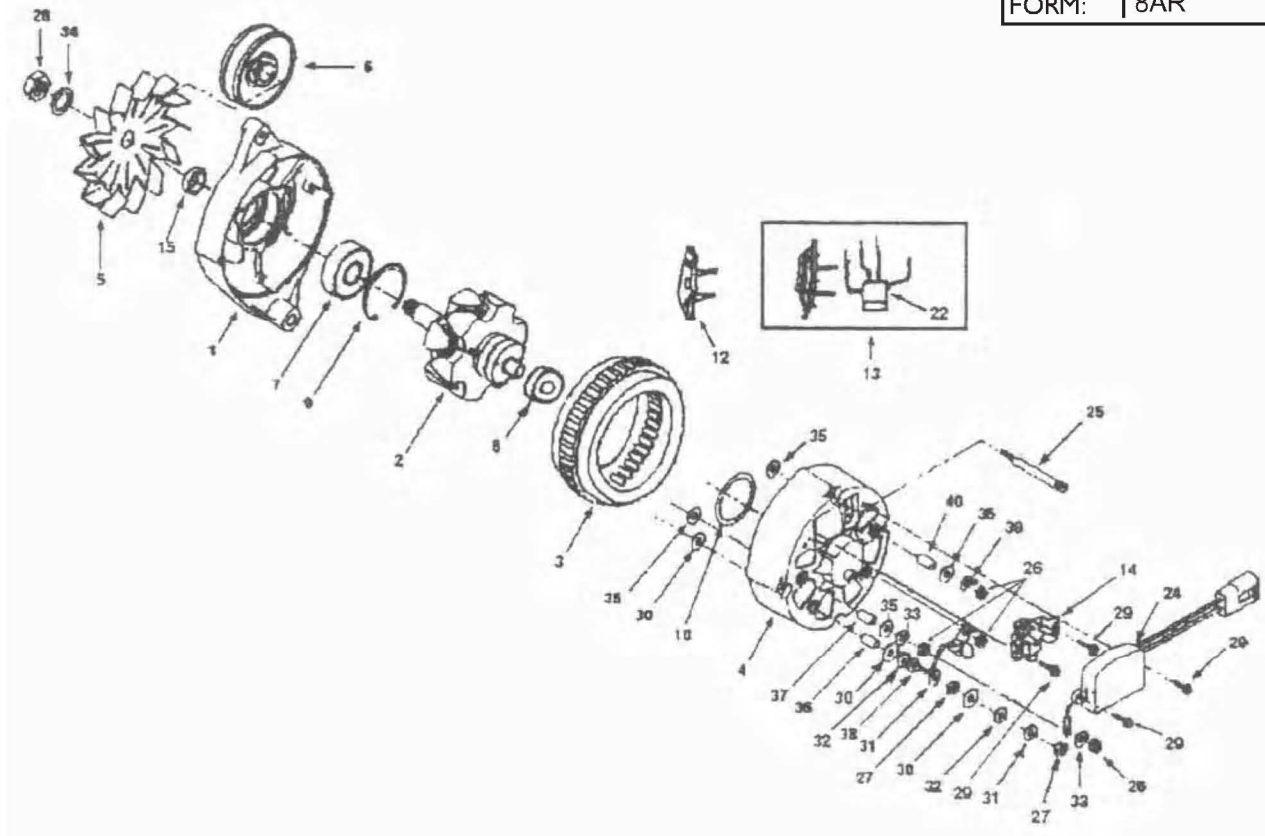

MODEL NO.	SALES NO.	13 DIODE REC. POS.	14 BRUSH ASSEM	15 SPACER FAN & PUL	16 WDRFF KEY 5	17 COV. BRU HOLDER	18 SHIELD DUST	19 CABLE ASSEM	20 CABLE, AC ASSEM	21 AC TAP ASSEM	22 DIODE TRIO	23	24 VOLT REG.
8AR2200L	110-460	101-227	103-39	120-372							101-228		105-301
8AR2201L	110-461	101-227	103-39	120-372							101-228		105-283
8AR2202L	110-463	101-227	103-39	120-372							101-228		105-301
8AR3200G	110-462	101-227	103-39	120-372							101-228		105-300

Important: The information contained in this bulletin is intended for use by trained, professional technicians who have the proper tools, equipment, and training to perform the required maintenance described above. This information is NOT intended for 'do-it-yourselfers', and you should not assume that this information applies to your equipment. If you have any questions regarding this information please visit our website at www.prestolite.com, or contact our technical service department at:

